

## Heavy duty pneumatic toggle clamps

Steel, Pneumatic, Heavy Duty

### SPECIFICATION

#### Type

- Type **EPV**: solid clamping arm

#### Coding

- Coding **M**: Magnetic piston

#### Body

cast steel  
black lacquered

#### other parts

Steel St 60  
zinc plated, blue passivated

#### Bearing pins

case-hardened

#### Double-action air cylinder

with adjustable cushioning  
max. pressure 6 bar

#### All moving parts

lubricated with special grease



### INFORMATION

GN 863 heavy duty pneumatic toggle clamps have been constructed in such a way as to make them easy to unmount: The bearing pins are axially fixed with circlips. This allows the clamping arm to be modified once it is dismantled, to suit any particular application.

To ensure an extended life of the mechanical parts as well as the air cylinder the operating pressure should not exceed 6 bar. In addition a lubrication control unit should be fitted in the air line.

Toggle clamps GN 861 have a magnetic piston. In conjunction with sensors GN 3380 (see page ) the end position can be sensed and the generated impulse can be used to transmit an electrical signal.

- General information for toggle clamps (see page 1560)

### ACCESSORY

- Sensor GN 3380 (see page )

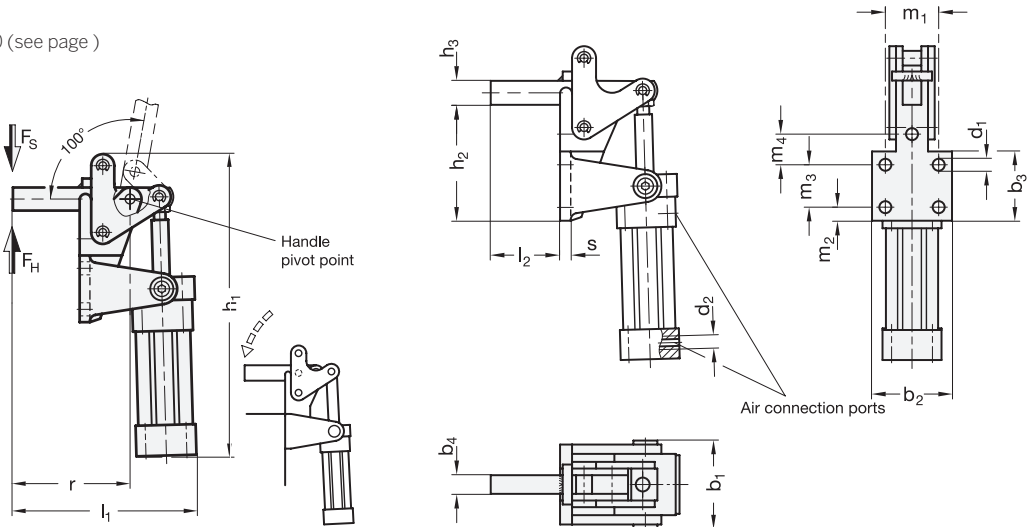

### GN 863

Description	Size	FH in N	Fs in N	b1 ≈ b2	b3	b4	d1	d2	Inside Ø connection tube	h1 ≈	h2	h3	l1 ≈	l2 ≈	m1	m2	m3	m4	r	s	⚖	
GN 863-1000-EPV-M	1000	10000	3250	102	90	80	20	10.5	G 1/4	8	355	132.5	25	217.5	80	50	12.5	50	-	144	13	5500
GN 863-2000-EPV-M	2000	20000	5600	112	100	90	20	12.5	G 3/8	10	425	161	35	246.5	100	54	12.5	58	45	168.5	14	8355